

Product overview

The world of natural colours and materials

Clay plasters and paints | Renovation systems

Modern earth building products | Building restoration materials





“Our passion for earth is what motivates us every day to find new solutions and develop new products – for you, your home and your environment.”

Jörg Meyer, Director of conluto

The benefits of conluto:

- Personal assistance
- Innovative solutions
- Ecologically sound
- Seminars and workshops
- Experts in earth building
- Since 1993

A better, simpler way of life!

Ecological building is no longer the niche market it once was. People now recognise the importance of building in ways that are in tune with the environment. Made only of pure earths and clay, conluto's products perfectly match the spirit of the age.

As specialists in earth building for more than 25 years, conluto have consistently striven to achieve the highest standards in the development and production of ecological earth building products.

Living with earth – a wise choice

Earth is a building material that unites tradition and modernity. Mankind has used earth as a natural building material for over 9000 years, and it can be found in much of our built heritage, for example as clay plaster. Today, this naturally occurring material is as diverse as the many centuries in which it has served as a building material and is also more innovative than ever. It's not hard to see why: few other building materials offer such excellent physical properties and are simultaneously abundantly available without harming the environment. Easy to recycle, and straightforward to use, earth is an exceptionally user-friendly building material – so much more than merely the earth beneath our feet.

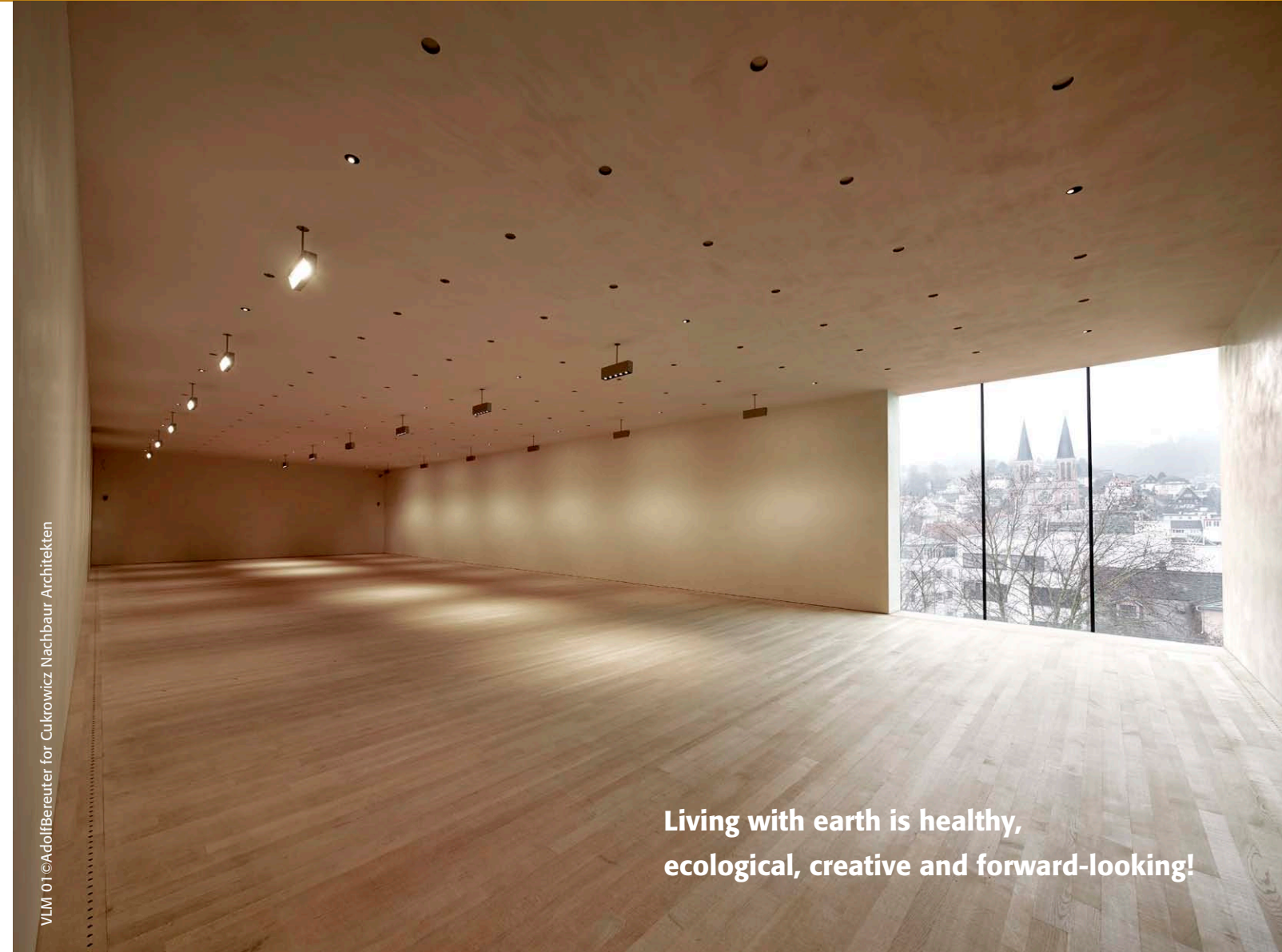

VLM 01 © Adolf Bereuter for Cukrowicz Nachbaur Architekten

Living with earth is healthy,
ecological, creative and forward-looking!

Vorarlberg Museum in Bregenz, Austria

The Vorarlberg Museum in Bregenz underwent comprehensive renovation and extension works in 2012 and 2013. The existing historical listed building was kept and enclosed almost entirely within a new modern building.

Clay plaster was used throughout, and by completion some 150,000 m² of the interior had been coated with clay plaster. A highly aesthetic deco facing plaster was specially developed by conluto for the museum, its colour shifting from light to warm grey as the light changes.

A particular challenge for the architects was to limit humidity fluctuation to less than 3 %. Taking a sustainable approach, they applied 3 cm layers of clay plaster to all the walls and 2.5 cm to the ceilings. Instead of full air-conditioning, the sorptive capacity of conluto's natural material regulates air humidity, to great effect!



Properties of clay plasters



Drying behaviour

As a purely mineral material, earth dries physically rather than chemically, hardening as it gives off moisture into the air.



Ease of use

Earth can be made malleable and reparable by adding water. This means the material can be worked for longer before it hardens, and that earth can be re-used and recycled without significant energy input.



Moisture transfer

With a low equilibrium moisture and high capillary conductivity, clay plasters dissipate moisture effectively, making them an ideal material for protecting wood and timber against excess moisture.



Positive indoor room climate

Clay plasters are vapour permeable (breathable) and help regulate indoor humidity levels. Earth can buffer fluctuations in air humidity (e.g. from showering, cooking or heating) by naturally absorbing and later releasing moisture from the air. This benefits the indoor room climate and reduces the risk of mould formation.



Absorbs odours and binds pollutants

Clay plasters bind odours: the clay minerals within the plaster can bind foreign substances and pollutants, effectively "cleaning" the indoor air.



Hypoallergenic

Clay plasters are hypoallergenic (mud has healing properties). They do not contain chemical additives or preservatives.



Non-electrostatic

Clay plasters have no electrostatic charge and therefore do not attract dust or dirt particles.



Excellent ecological balance

Clay plasters conserve resources, requiring minimal energy for their manufacture. The extraction and refinement of earth for clay plasters does not blight the landscape and does not pollute air or water.

Earth and clay building materials are easy to work and easy to apply and their unique capacity to naturally regulate air humidity levels far exceeds that of many other conventional building materials.

Designing and building with earth is not only an investment in modern, forward-looking interiors but also in one's future health and the environment – all DIN-conform earth building materials by conluto are made of 100 % natural materials.

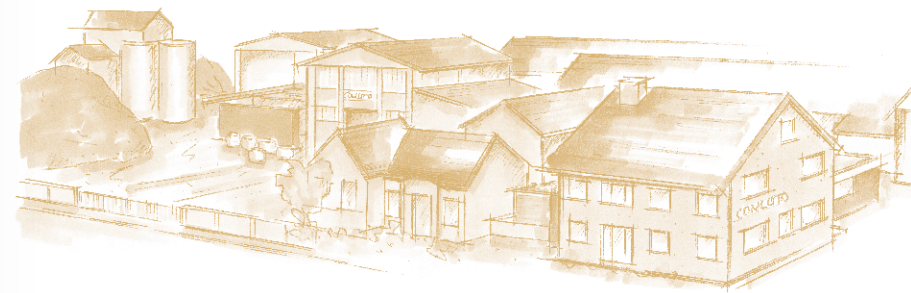

Ecological, healthy, modern – conluto

conluto earth building materials and the conlino range of natural coloured paints and plasters exhibit the rich variety of different earths in Germany and **combine tradition with innovation.**

The result:

a diverse range of earth building products for all purposes with naturally beautiful colours and no chemicals.

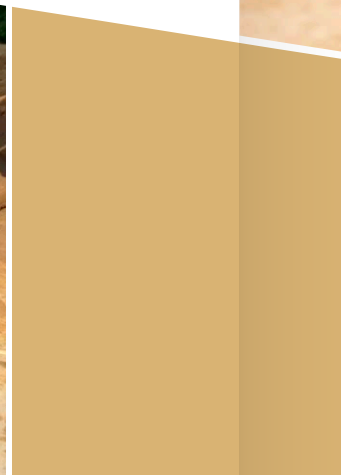

Contents

Clay plasters and paints

Clay plasters with organic additives

Clay undercoat plaster 7

Clay finish coat plaster 7

Clay fine-finish plaster 8

Clay adhesive and reinforcing mortar 8

Clay plasters without organic additives

Terra clay plaster, coarse and fine 8

Plaster reinforcement fabric 9

conlino surface finishes 10

Substrate pre-treatment 12

conlino clay paints 13

conlino brush-applied clay plaster additive 14

conlino deco clay facing plaster 14

conlino clay smoothing plaster 15

conlino surface finish effect materials, tools, stencils 16

conlino Japanese fine plaster trowels, samples case, colour samples catalogue 17

Renovation systems

Light earth bricks 18

Light earth masonry mortar 18

Triangular battens 18

Lime plasters 19

Wood fibre insulation boards 19

Insulation fasteners 20

Reveal boards 20

Wool for stuffing 20

Light clay 21

Reed boards 21

Modern earth building products

Clay panels 22

Rammed earth 22

Surface treatments for clay smoothing plaster and rammed earth .. 23

High-mass earth bricks 23

Earth masonry mortar, dense 24

Loam fill material 24

Trickle protection fleece 24

Building restoration materials

Straw-clay 25

Building clay 25

Earth reels 25

Plant fibres and animal hairs 26

Retailers 26

Contact details, product folder 27

Clay plasters with organic additives

Clay undercoat plaster

Clay undercoat plaster		Packaging unit	Sales unit	Weight kg/packaging unit
Naturally moist Clay plaster mortar DIN 18947 – LPM 04 f – S II – 1,8				
05.001	Clay undercoat plaster, naturally moist, supplied in big bags (1.2 t/big bag) or as loose material; straw fibre length ~30 mm; coverage: ~75 m² at a thickness of 1 cm; supplied on euro pallets	m³ loose material	1	1200
05.001.1		Big Bag	1	1200
05.001.2		Big Bag	1	600
Dry Clay plaster mortar DIN 18947 – LPM 02 f – S II – 1,8				
05.002.1	Clay undercoat plaster, dry, 1 t/big bag; straw fibre length < 30 mm; coverage: ~68 m² at a thickness of 1 cm; supplied shrink-wrapped on euro pallets	Big Bag	1	1000
05.002	Clay undercoat plaster, packaged in sacks, straw fibre length ~30 mm, 25 kg/sack, 42 sacks/euro pallet; coverage: ~1.7 m² at a thickness of 1 cm; supplied shrink-wrapped on euro pallets	Sack	1	25

Clay undercoat plaster is a mixture of clay-rich earth, sand and chopped straw and can be applied at a thickness of up to 3 cm in a single layer. It is supplied in pre-mixed naturally moist form, packaged in sacks or as loose dry ready-mix plaster. Dry clay undercoat plaster is suitable for use with closed plastering machines, e.g. mixing pump types G4 and G5.

Clay finish coat plaster

Clay finish coat plaster		Packaging unit	Sales unit	Weight kg/packaging unit
Naturally moist Clay plaster mortar DIN 18947 – LPM 04 f – S II – 1,8				
05.010.1	Clay finish coat plaster, naturally moist, supplied in big bags (1.2 t/big bag); straw fibre length ~10 mm; coverage: ~75 m² at a thickness of 1 cm; supplied on euro pallets	Big Bag	1	1200
05.010.2		Big Bag	1	600
Dry Clay plaster mortar DIN 18947 – LPM 02 f – S II – 1,8				
05.011.1	Clay finish coat plaster, dry, 1 t/big bag; straw fibre length 10 mm; coverage: ~68 m² at a thickness of 1 cm; supplied shrink-wrapped on euro pallets	Big Bag	1	1000
05.011	Clay finish coat plaster, packaged in sacks; straw fibre length ~10 mm, 25 kg/sack, 42 sacks/euro pallet; supplied shrink-wrapped on euro pallets; coverage: ~1.7 m² at a thickness of 1 cm	Sack	1	25



Clay finish coat plaster is a mixture of clay-rich earth, sand and straw and is typically applied at a thickness of up to 1 cm. The plaster is supplied pre-mixed and naturally moist, and packaged in sacks. Dry clay finish coat plaster is suitable for use with closed plastering machines, e.g. mixing pump types G4 and G5.



- Clay plasters in accordance with DIN 18947
- 25 years of expertise
- Earth and sand from regional sources

Clay plasters with organic additives

Clay fine-finish plaster

		Packaging unit	Sales unit	Weight kg/packaging unit		
Dry Clay plaster mortar DIN 18947 – LPM 0/0,5 f – S II – 1,8						
10.013.1	Clay fine-finish plaster, dry, 1 t/big bag, with plant fibres; coverage: ~240 m² at a thickness of 3 mm; supplied shrink-wrapped on euro pallets	Big Bag	1	1000		
10.013	Clay fine-finish plaster, packaged in sacks, with plant fibres, 25 kg/sack, 42 sacks/supplied shrink-wrapped on euro pallets; coverage: ~6 m² at a thickness of 3 mm	Sack	1	25		



Clay fine-finish plaster is applied at thickness of 1 – 3 mm and skimmed flat or rubbed with a float. It consists of clay-rich earth, fine grain sand > 5 mm and fine organic fibres. It is suitable for machine processing in closed plastering machines, e.g. mixing pump types G4 and G5 or similar.

Clay adhesive and reinforcing mortar

	Packaging unit	Sales unit	Weight kg/packaging unit	
10.014				
Clay adhesive and reinforcing mortar, packaged in sacks, 42 sacks/supplied shrink-wrapped on euro pallets; contains plant fibres, cellulose and organic starch; coverage: ~6.5 m² at a thickness of 3 mm	Sack	1	25	

conluto clay adhesive and reinforcing mortar is a dry ready-mixed mortar with exceptional adhesive properties thanks to the addition of cellulose and organic starch. It can be used to affix insulation and clay building panels, to bed a reinforcement mesh or as a thinset mortar applied with a notched trowel.

Clay plasters without organic additives

Terra clay plaster, coarse, naturally-moist Clay plaster mortar DIN 18947 – LPM 04 m – S II – 1,8		Packaging unit	Sales unit	Weight kg/packaging unit	
05.003.1	Terra clay plaster, coarse (1.2 t/big bag), naturally moist, no additives; coverage: ~72 m² at a thickness of 1 cm, suitable for use as undercoat or finish coat plaster; supplied shrink-wrapped on euro pallets; application thickness: 5 – 15 mm	Big Bag	1	1200	
05.003.2		Big Bag	1	600	
Terra clay plaster, coarse, dry Clay plaster mortar DIN 18947 – LPM 02 m – S II – 1,8					
05.005.1	Terra clay plaster, coarse (1.2 t/big bag), dry, no additives; coverage: ~68 m² at a thickness of 1 cm, suitable for use as basecoat and topcoat plaster; supplied shrink-wrapped on euro pallets; application thickness: 5 – 15 mm	Big Bag	1	1000	
05.005	Terra clay plaster, packaged in sacks, no additives, 25 kg/sack, 42 sacks/shrink-wrapped euro pallet; coverage: ~1.7 m² at a thickness of 1 cm, suitable for use as basecoat and topcoat plaster; application thickness: 5 – 15 mm	Sack	1	25	
Terra clay plaster, fine Clay plaster mortar DIN 18947 – LPM 01 m – S II – 1,8					
05.004.1	Terra clay plaster, naturally moist (1.2 t/big bag), Ø ~0 – 1 mm, may contain oversize grains up to Ø 2 mm, no additives, coverage: ~180 m² at a thickness of 4 mm, application thickness: 3 – 4 mm; supplied shrink-wrapped on euro pallets	Big Bag	1	1200	
05.004.2		Big Bag	1	600	

Terra clay plasters are supplied ready-mixed and naturally moist and are suitable for processing with plastering machines. It consists of clay-rich earth and mixed-grain sand and has a bulk density of ~1800 kg/m³. The granularity of the coarse terra clay plaster lies between that of the clay undercoat plaster and clay finish coat plaster but contains no added straw. This plaster is safe for people with an allergy to grasses.

Plaster reinforcement fabric

		Packaging unit	Sales unit	Weight kg/packaging unit
35.001	Hessian reinforcement fabric, 125 g/m², 1 × 50 m, 50 m²/roll	Roll	1	6.3
35.003	Hessian joint reinforcement scrim, 200 g/m², 0.10 × 50 m, 50 linear m/roll	Roll	1	1.11
35.005	Glass-fibre mesh reinforcement, 160 g/m², 1 × 50 m, 50 m²/roll, mesh size: 7 × 7 mm	Roll	1	8
35.005.10	Glass-fibre mesh joint reinforcement scrim, 155 g/m², 0.10 × 50 m, 50 linear m/roll	Roll	1	0.8

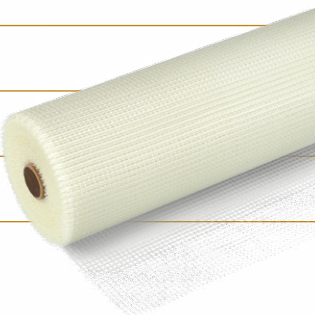

Plaster reinforcement is always required where the substrate material changes from blockwork masonry to a panel material.

Working with clay plasters

DIN norms for earth building materials

In August 2013, the new DIN norms for earth blocks (DIN 18945), earth masonry mortars (DIN 18946) and earth plaster mortars (DIN 18947) came into force, providing the basis for ensuring uniform, comparable and reliable quality assurance standards for earth building materials in Germany. conluto’s existing range of building materials conforms to the quality criteria outlined in the DIN norms. conluto’s DIN-conforming products are marked in the product catalogue and on the packaging.

Further information on the DIN declarations is available online on www.conluto.de

How should surfaces for plastering with clay plasters be?

- Rough and slightly absorbent
- Clean and free of dust and loose particles
- Offer good mechanical adhesion; where necessary pre-treat with a clay slurry

Clay plasters and indoor room climate

- Clay plasters help regulate humidity levels in rooms
- Clay plasters can absorb odours
- Clay plasters are antistatic and less susceptible to dust accumulation

Correct storage of big bags

- Protect from direct sunlight
- Leave big bags on pallets, rather than directly on the ground
- For long-term storage, cover with a loose shrink-wrap
- Naturally moist material can only be stored for a maximum of 3 months
- Naturally moist earth products can freeze during the winter months without affecting the quality of the product, and then re-used once thoroughly thawed

- ➔ Please see technical work sheet 5.1 Clay plasters
- ➔ When using conluto clay plasters in plastering machines, please see our corresponding work sheet 5.2.

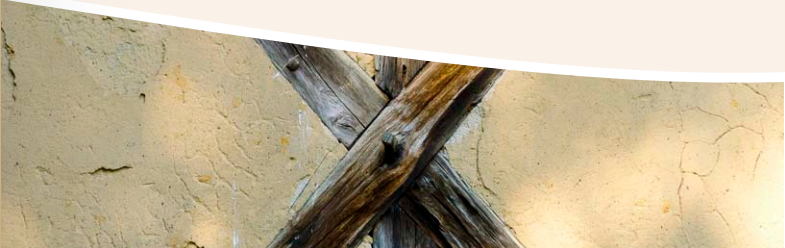

conlino
colours of clay

Four conlino surface finishes for a range of creative possibilities

Mother Nature created the earth in many colours – conlino products add nothing, preserving their natural beauty.

conlino products are available in four surface finishes:

- Clay paint
- Brush-applied clay plaster
- Deco clay facing plaster
- Clay smoothing plaster

Clay paints have an even, matt surface appearance, while brush-applied clay plasters give surfaces a fine granular surface texture. Deco clay facing plasters are mixed with fine quartz sand to create a subtle cloudy, shimmering surface finish. Further decorative additives or working techniques can also be used to create additional effects. For especially refined interiors and highly specific surface finishes, conlino smoothing plasters are the perfect choice.

Comfort and aesthetics

As a 100 % natural product, conlino paint and plaster is pure in appearance, unmistakably authentic, and sustainable in its composition.

The conlino range of earth-based products unite comfort, health and aesthetics in an exceptional way. The evocative colours of the conlino range, made of selected coloured earths and clay minerals, lend interiors an atmosphere of warmth and character, and a unique sense of living comfort.

Drawing on our years of experience, we have created a refined blend of selected earths and clays from throughout Germany that exhibit incomparable depth and brilliance.

Health and sustainability together with excellent humidity regulating properties mean that conlino products meet the highest ecological standards and aesthetic requirements.



Clay paint
honest & aesthetic



Brush-applied clay plaster
light & shimmering

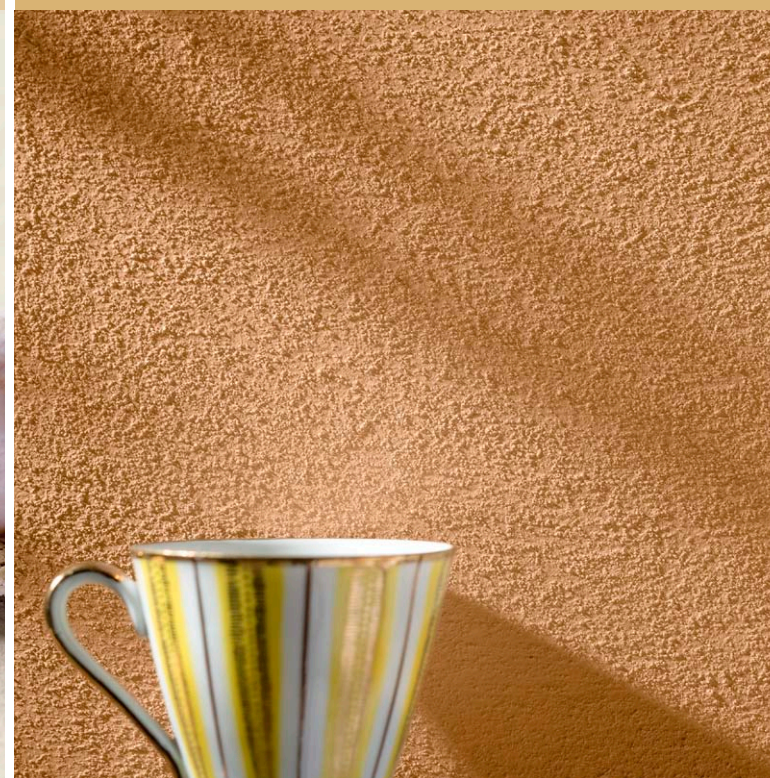

Deco clay facing plaster
lively & individually



Clay smoothing plaster
exclusive & modern



Substrate pre-treatment

Wall and ceiling primer

coarse – Bonding course for clay plasters and deco clay facing plasters



		Packaging unit	Sales unit	Weight kg/packaging unit
00.990.3	Wall and ceiling primer, for clay plasters and deco clay facing plasters, with coarse, granular texture, 5 l bucket; coverage approx. 7 – 12 m²/l	Bucket	1	7.4
00.990.4	Wall and ceiling primer, for clay plasters and deco clay facing plasters, with coarse, granular texture, 10 l bucket; coverage approx. 7 – 12 m²/l	Bucket	1	14.8



- improved recipe
- contains no preservatives
- much higher coverage

The wall and ceiling primer, coarse, is a white, textured priming coat made of plant ester as a bonding course for a subsequent coat of clay plaster or deco clay facing plaster in interiors. It can be applied to all substrates, including dry lining boards or concrete.

Clay wall and surface filler

sandable – For creating smooth, fine-finish surfaces for subsequent coloured paints or plasters



		Packaging unit	Sales unit	Weight kg/packaging unit
00.991	Clay wall and surface filler, 20 kg/sack, 42 sacks; supplied shrink-wrapped on euro pallets; coverage approx. 20 m² at a thickness of 1 cm	Sack	1	20



Clay wall and surface filler is a sandable, machine-pumpable premixed filler compound for creating very fine and smooth surfaces for subsequent painting or coating and for filling and smoothing irregular substrates, for filling holes, cracks and large irregularities in walls and ceilings, for closing and filling joints between clay panels and for embedding plaster reinforcement mesh or scrim tape.

Casein primer

for evening out the suction of substrates and stabilizing clay plasters

		Packaging unit	Sales unit	Weight kg/packaging unit
00.990.5	Casein primer for clay paints, brush-applied plasters and smoothing plasters, fine consistency, 250 g powder in a bag; coverage ~40 – 60 m²; also suitable as a fixative for clay plaster surfaces;	Bag	1	0.25

Casein primer is a multi-purpose transparent primer for conluto clay paints, brush-applied plasters and smoothing plasters and as a fixative for exposed clay plaster surfaces. It reduces the absorbency (suction) of highly absorbent substrates, evening out different degrees of suction in the substrate to ensure a homogenous appearance of the plastered surface.



conlino clay paints

19.400.2	conlino clay paint for walls and ceilings in interiors; coverage: approx. 70 – 130 g/m² depending on substrate and coating; 50 x 5 kg buckets / euro pallet; 32 x 10 kg buckets / euro pallet
19.400.3	
19.410.2	
19.410.3	
19.411.2	
19.412.2	
19.413.2	
19.414.2	
19.415.2	
19.416.2	
19.416.3	
19.417.2	
19.417.3	
19.418.2	
19.419.2	
19.419.3	
19.420.2	
19.421.2	
19.422.2	
19.423.2	
19.424.2	
19.425.2	
19.426.2	
19.427.2	
19.428.2	
19.429.2	
19.430.2	
19.431.2	
19.432.2	
19.433.2	
19.434.2	
19.436.2	
19.437.2	
19.438.2	
19.439.2	
19.440.2	
19.441.2	
19.441.3	
19.442.2	
19.442.3	
19.443.2	
19.444.2	

Packaging unit	Colour number	Colour name	Sales unit	Weight kg/packaging unit
Bucket	CL 100	Edelweiss	1	5 10
Bucket	CL 102	Ivory	1	5 10
Bucket	CL 103	Powder	1	5
Bucket	CL 104	Marl	1	5
Bucket	CL 105	Bilbao	1	5
Bucket	CL 106	Pebble	1	5
Bucket	CL 107	Elephant	1	5
Bucket	CL 108	Sandstone	1 1	5 10
Bucket	CL 109	White clay	1 1	5 10
Bucket	CL 110	Ardesia	1	5
Bucket	CL 111	Light Bilbao	1 1	5 10
Bucket	CL 112	Bailey	1	5
Bucket	CL 113	Barro Tinaja	1	5
Bucket	CL 114	Tinaja	1	5
Bucket	CL 120	Red clay	1	5
Bucket	CL 121	Chestnut	1	5
Bucket	CL 122	Siena	1	5
Bucket	CL 123	Massada	1	5
Bucket	CL 124	Morocco yellow	1	5
Bucket	CL 125	Arancio	1	5
Bucket	CL 126	Provence red	1	5
Bucket	CL 127	Provence yellow	1	5
Bucket	CL 130	Herculanum	1	5
Bucket	CL 131	Blue clay	1	5
Bucket	CL 132	Paloma grey	1	5
Bucket	CL 133	Baptismal blue	1	5
Bucket	CL 136	Light green clay	1	5
Bucket	CL 137	Verona	1	5
Bucket	CL 138	Light Verona	1	5
Bucket	CL 139	Pompeji	1	5
Bucket	CL 140	Ochre clay	1	5
Bucket	CL 141	Light ochre clay	1 1	5 10
Bucket	CL 142	Golden cypress	1 1	5 10
Bucket	CL 143	Gold clay	1	5
Bucket	CL 146	Shell	1	5



- Earth serves simultaneously as binder and filler and gives the material its colour.
- conluto clay paints, brush-applied plasters, deco facing plasters and smoothing plasters are high-quality surface finishes made of clays and earths.

conlino clay paint has an even, matt, slightly cloudy surface finish and has good filling and coverage properties. They are easy to use and can be applied to all suitably absorbent surfaces in interiors. conlino clay paints can be rolled, brushed or sprayed.





conlino
brush-applied clay plaster additive

		Packaging unit	Sales unit	Weight kg/packaging unit
19.505	conlino brush-applied clay plaster additive for a granular surface texture; 1700 g for a 5 kg bucket of clay paint; 16 bags/ box	Bag	1	1.7

conlino brush-applied clay plaster additive can be used to create a granular, textured coating for creating fascinating surface effects in interiors. conlino brush-applied clay plaster gives walls texture.



conlino
deco clay facing plaster

		Packaging unit	Colour number	Colour name	Sales unit	Weight kg/packaging unit
19.300	conlino deco clay facing plaster, coloured, 25 kg/sack, 42 sacks/shrink-wrapped euro pallet; coverage: ~9 m² at a thickness of max. 2 mm	Sack	CP 100	Edelweiss	1	25
19.311		Sack	CP 102	Ivory	1	25
19.315		Sack	CP 106	Pebble	1	25
19.318		Sack	CP 109	White clay	1	25
19.319		Sack	CP 110	Ardesia	1	25
19.320		Sack	CP 111	Light Bilbao	1	25
19.323		Sack	CP 114	Tinaja	1	25
19.324		Sack	CP 120	Red clay	1	25
19.325		Sack	CP 121	Chestnut	1	25
19.329		Sack	CP 125	Arancio	1	25
19.331		Sack	CP 127	Provence yellow	1	25
19.333		Sack	CP 131	Blue clay	1	25
19.336		Sack	CP 135	Green clay	1	25
19.341		Sack	CP 140	Ochre clay	1	25
19.342		Sack	CP 141	Light ochre clay	1	25
19.345		Sack	CP 146	Shell	1	25



conlino deco clay facing plaster is a thin-layer, pre-coloured facing plaster for decorative and healthy interior finishes. It is suitable for all smooth, plasterable substrates. The plaster consists of a mixture of selected earths and clays and fine additives such as quartz sand, resulting in a slightly cloudy, shimmering surface. A range of other additives can be used to achieve creative and individual surface finishes. Deco clay facing plaster is applied with a stainless steel smoothing trowel.



All conlino deco clay facing plasters can be provided on request in half-size or full-size big bags with the article number 19._.2 (quantity: 500 kg) or article number 19._.1 (quantity: 1000 kg).



conlino
clay smoothing plaster

		Packaging unit	Colour number	Colour name	Sales unit	Weight kg/packaging unit
19.601	Vapour-permeable, high-quality smoothing plaster for interiors; quantity depends on the absorbency (suction) of the substrate, 400 g/m² per layer; 50 x 5 kg buckets/ euro pallet;	Bucket	CG 100	Edelweiss	1	5
19.602		Bucket	CG 102	Ivory	1	5
19.603		Bucket	CG 105	Bilbao	1	5
19.604		Bucket	CG 110	Ardesia	1	5
19.605		Bucket	CG 113	Barro Tinaja	1	5
19.606		Bucket	CG 120	Red clay	1	5
19.607		Bucket	CG 121	Chestnut	1	5
19.608		Bucket	CG 125	Arancio	1	5
19.609		Bucket	CG 126	Provence red	1	5
19.610		Bucket	CG 131	Blue clay	1	5
19.611		Bucket	CG 137	Verona	1	5
19.612		Bucket	CG 146	Shell	1	5

Clay smoothing plaster is applied in two thin layers with a Japanese trowel. For an especially deep surface effect, a third coat can also be applied once the underlying layers have thoroughly dried. Clay smoothing plasters can be used to create perfectly smooth individual surfaces for especially refined living interiors.



Request a copy of our colour swatch card for clay paints, deco facing plasters and smoothing plasters, and see our brochure on “Living rooms designed with clay plaster.”



Detailed information on working with and applying conlino surface finish products is available in our work sheet 6.1: Designing surface finishes.



© Jens Kirchner



Surface finish effect materials

		Packaging unit	Sales unit	Weight kg/packaging unit	
50.030	Chopped straw, straw fibre length ~8 mm, additive for facing clay plaster; max mixing proportion: 105 g for 25 kg	Bag	1	0.11	
50.031	Ground pearl, finely ground pearl shells lend coloured plasters a pearlescent shimmer, grain size: 0.8 – 1.2 mm; 1 kg/bag; max mixing proportion: 10 %	Bag	1	1	
50.033	Real mica (phlogopite mica), ~1 – 2 mm; 500 g; lends coloured plasters a special shine; max mixing proportion: 3 %	Bucket	1	0.5	
50.034	Mica mineral, expanded (vermiculite), 250 g, grain size: ~3 – 4 mm, lends a deco clay facing plaster a special structure, max mixing proportion: 2 %	Bucket	1	0.25	

Surface finish effect materials are mixed into the plaster to lend wall surfaces a special surface quality, for example a pearlescent shimmer or glints of strands of golden straw.

Tools

		Packaging unit	Sales unit	Weight kg/packaging unit	
50.081	Glaze brush, oval, brush length: 70 mm, 130 × 60 mm, bristles set in vulcanized rubber	Item	1	0.26	
50.005	Sponged float, coarse texture, orange, plastic, 140 × 280 × 17 mm	Item	1	0.31	
50.004	Sponged float, fine texture with white latex surface, plastic, 140 × 280 × 17 mm	Item	1	0.32	

Tools are the equipment we use to work surfaces and materials and a means of extending our physical skills and capacity. We offer a range of professional tools for working with our earth building products. They complement our materials and products and are an indispensable aid in working with them.

Stencils

For especially attractive wall designs, we offer a range of stencils made of 250 µm thick reusable stencil foil in different sizes – designed by the artist “Markus Wortmann touch of art”.

See our stencil catalogue online: www.conluto.de

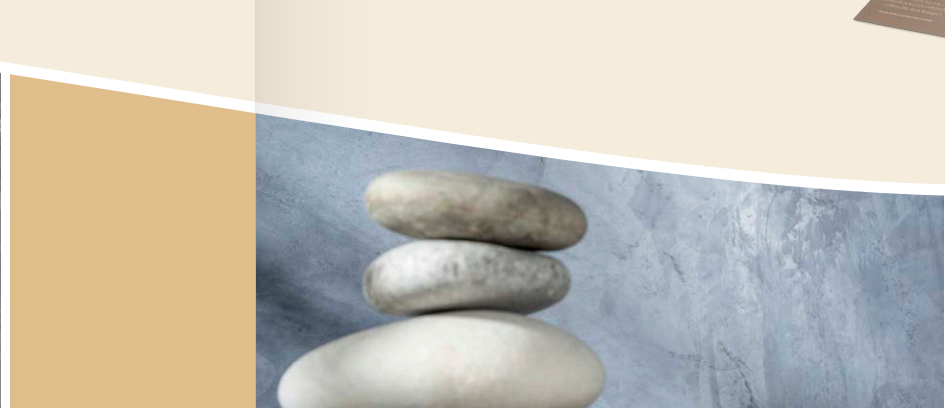

Japanese fine plaster trowels

		Packaging unit	Sales unit	Weight kg/packaging unit	
50.902.18	Japanese fine plaster trowel, very fine, pointed, flexible blade of hardened and polished stainless steel; dimensions: 180 × 55 × 0.3 mm	Item	1	0.1	
50.902.21	Japanese fine plaster trowel, very fine, pointed, flexible blade of hardened and polished stainless steel; dimensions: 210 × 65 × 0.3 mm	Item	1	0.13	
50.903.21	Japanese fine plaster trowel, special plastic, especially suited for finishing work; dimensions: 210 × 60 × 1 mm	Item	1	0.08	
50.900.24	Japanese fine plaster trowel, very fine, rectangular, flexible blade of hardened and polished stainless steel; dimensions: 240 × 75 × 0.4 mm	Item	1	0.2	
50.901.24	Japanese fine plaster trowel, very fine, rounded, flexible blade of hardened and polished stainless steel; dimensions: 240 × 80 × 0.3 mm	Item	1	0.18	

The path to perfecting one’s craft is with the right tools. Japan has a rich tradition of using clay plaster and the quality of the surface is a matter of pride. Special tools were developed to assist the craftsmen. We have put together a small collection of the most useful Japanese fine plaster trowels.

conlino samples case

102.007 Real sample boards of the complete conlino product range (clay paints, brush-applied clay plaster, deco facing plasters, smoothing plasters)



conlino colour samples catalogue

Sample boards in a practical box for transportation

102.002 clay paints / brush-applied clay plaster
102.004 deco clay facing plasters with and without finish effect materials
102.003 clay smoothing plaster



- Earth bricks in accordance with DIN 18945
- Traditionally hand-formed

Light earth bricks

Non-load-bearing

		Packaging unit	Sales unit	Weight kg/packaging unit
Light earth bricks – non-load-bearing – DIN 18945 – LS f – I a				
07.011	Light earth bricks NF 1200, 416 bricks/pallet, bulk density: 1200 kg/m³, (S-format 247 x 120 x 69 mm); application class Ia	Bricks	416	2.4
07.012	Light earth bricks NF 800, 416 bricks/pallet, bulk density: 800 kg/m³, (S-format 247 x 120 x 69 mm); application class Ia	Bricks	416	1.6
07.013	Light earth bricks 2DF 700, 350 bricks/shrink-wrapped pallet, bulk density: 700 kg/m³, (2DF = 2 x Thin Format: 240 x 115 x 113 mm); application class Ia	Bricks	350	2.3
07.015	Light earth bricks 3DF 700, 246 bricks/ shrink-wrapped pallet, bulk density: 700 kg/m³, (3DF = 3 x Thin Format: 240 x 175 x 113 mm); application class Ia	Bricks	246	3.3

Light earth bricks are formed in a process inspired by the hand-made process of making bricks. NF 1200 light earth bricks are especially suited for use as brickwork infill panels in timber-frame constructions. All light earth bricks are suitable for indoor use for non-load-bearing partitioning walls and wall lining layers. The different bulk densities are achieved through the addition of organic additives.

Light earth mortar

Non-load-bearing

		Packaging unit	Sales unit	Weight kg/packaging unit
Earth masonry mortar DIN 18946 – LMM 04 f – M 0 – 1,2				
05.022.1	Light earth masonry mortar (1 t/big bag), supplied in big bags, naturally moist, for use with light earth bricks, straw fibre length ~20 mm; supplied on euro pallets; yield according to usage table (see conluto product folder, printed or online)	Big Bag	1	1000
05.022.2		Big Bag	1	500

Light earth masonry mortar is a ready-mixed, naturally moist mortar made of ground clay-rich earth, mixed grain sand and chopped straw or sawdust. It is used for laying earth bricks.

Triangular battens

		Packaging unit	Sales unit	Weight kg/packaging unit
40.001	Triangular battens, oak, 50 linear m/bundle, each 1 m long	Bundle	1	12

Triangular battens are used with brick infill in the panels of timber-frame constructions. Attached to the inner faces of the timber posts, they hold the brickwork in place.

Wall linings of light earth masonry

Wall linings made of light earth brickwork consist of an inner leaf of masonry wall. This technique has the advantage that it dries quickly and can be used to correct irregularities in existing wall surfaces, resulting in a straight interior wall surface.

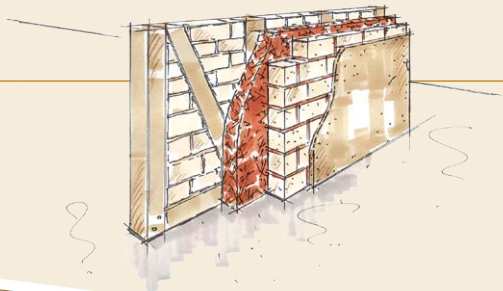

Lime plaster

		Packaging unit	Sales unit	Weight kg/packaging unit
05.030	Schäfer trass lime plaster 455 coarse; Ø 0 – 4 mm, 30 kg/sack, 36 sacks/ shrink-wrapped euro pallet; coverage: max. 2.1 m² at a thickness of 1 cm	Sack	1	30
05.031	Schäfer trass lime plaster 450 fine; Ø 0 – 1.25 mm, 30 kg/sack, 36 sacks/ shrink-wrapped euro pallet; coverage: max. 2.1 m² at a thickness of 1 cm	Sack	1	30

Schäfer lime plasters are leaned with hard limestone sand. They exhibit a high degree of elasticity and vapour permeability, and adhere well to substrates made of conluto earth building materials. The vapour permeability value, $\mu = 7 - 10$. Both plaster mortars can be used for indoor plaster or external render.

- Bulk density: 180 kg/m³
- Bulk density PAVADENTRO: 175 kg/m³

Wood fibre insulation boards

		Packaging unit	Sales unit	Weight kg/packaging unit
D35.028.2	conluto insulation system, thickness: 40 mm, dimensions: 120 x 80 cm, 0.96 m²/board, wood fibre insulation board, plasterable, 26 boards/shrink-wrapped pallet = 24.96 m²	m²	0.96	7.2
D35.028.3	conluto insulation system, thickness: 60 mm, dimensions: 120 x 80 cm, 0.96 m²/board, wood fibre insulation board, plasterable, 17 boards/shrink-wrapped pallet = 16.32 m²	m²	0.96	10.8
D35.029.2	conluto PAVADENTRO 80, thickness: 80 mm, dimensions: 102 x 60 cm, 0.61 m²/board, wood fibre insulation board, plasterable, 56 boards/shrink-wrapped pallet = 34.30 m²	m²	0.61	14
D35.029.3	conluto PAVADENTRO 100, thickness: 100 mm, dimensions: 102 x 60 cm, 0.61 m²/board, wood fibre insulation board, plasterable, 44 boards/shrink-wrapped pallet = 26.90 m²	m²	0.61	17.5

Larger amounts on request.

These wood fibre insulation boards with tongue-and-groove edging can be plastered on directly and conform to the stipulations set out in DIN 68755. They are made of offcut material from sawmills such as flitches and spikes from coniferous woods bonded without the use of artificial adhesives.

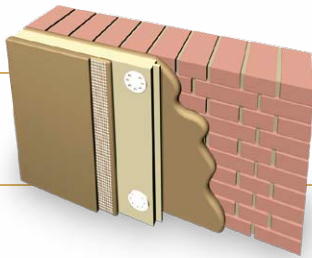

conluto internal insulation system



The conluto internal insulation system consists of a thermally optimised wood fibre insulation board coated with clay plaster. The system offers optimal capillary conductivity and a high condensation retention capacity. Designed especially for insulating the inner face of external walls, it can be used as internal insulation without the need for a vapour barrier.

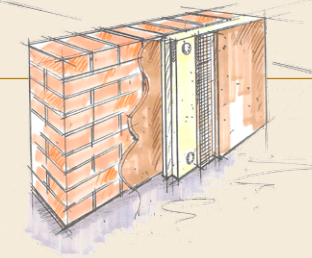
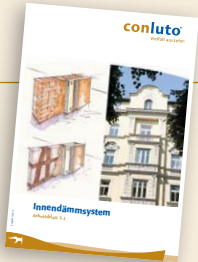

Please see our work sheet 2.1 Internal insulation systems.



Insulation fasteners

		Packaging unit	Sales unit	Weight kg/packaging unit	
35.050	Insulation screw anchor, 125 mm, pre-assembled screw anchor, corrosion protected, Ø 60 mm anchor plate, with ball cap, incl. 1 special bit 1/4" DIN 3126, T 30 × 50 mm, 100 pieces	Box	1	3.0	
35.051	Insulation screw anchor, 145 mm, pre-assembled screw anchor, corrosion protected, Ø 60 mm anchor plate, with ball cap, incl. 1 special bit 1/4" DIN 3126, T 30 × 50 mm, 100 pieces	Box	1	3.4	
35.052	Insulation screw anchor, 165 mm, pre-assembled screw anchor, corrosion protected, Ø 60 mm anchor plate, with ball cap, incl. 1 special bit 1/4" DIN 3126, T 30 × 50 mm, 100 pieces	Box	1	3.8	
35.053	Insulation screw anchor, 185 mm, pre-assembled screw anchor, corrosion protected, Ø 60 mm anchor plate, with ball cap, incl. 1 special bit 1/4" DIN 3126, T 30 × 50 mm, 100 pieces	Box	1	4.02	
35.054	Insulation screw anchor, 205 mm, pre-assembled screw anchor, corrosion protected, Ø 60 mm anchor plate, with ball cap, incl. 1 special bit 1/4" DIN 3126, T 30 × 50 mm, 100 pieces	Box	1	4.41	
35.055	Insulation screw anchor, 225 mm, pre-assembled screw anchor, corrosion protected, Ø 60 mm anchor plate, with ball cap, incl. 1 special bit 1/4" DIN 3126, T 30 × 50 mm	Box	1	4.79	
35.020	cl insulation fastener, Ø 65 mm, 100 pieces	Box	1	1.0	

The anchor length should be chosen to correspond with the insulation thickness and the underlying material. Screw anchors are for masonry and insulation fasteners for timber elements. A special bit (free in each box) is required for the correct mounting and expansion of the screw anchors 35.050 – 35.055.

Reveal boards

		Packaging unit	Sales unit	Weight kg/packaging unit
D35.021.3	Reveal board, 20 mm, square edge profile, 110 × 60 cm, 8 boards/packet = 5.28 m²/packet	m²	5.28	3.7
D35.021.4	Reveal board, 40 mm, square edge profile, 110 × 60 cm, 4 boards/packet = 2.64 m²/packet	m²	2.64	7.4

Wool for stuffing

		Packaging unit	Sales unit	Weight kg/packaging unit
35.036	Wool made of hemp fibres, ideal for plugging small openings and difficult to reach gaps; for thermal and noise insulation, 10 kg/box	Box	1	10

Hemp wool is used for stuffing into all gaps greater than 2 mm wide, for example when installing doors and windows, and for cavities between rafters and gable walls or gaps at the junction between conluto insulation panels and walls, ceilings or ceiling joists.

Light clay

		Packaging unit	Sales unit	Weight kg/packaging unit	
03.054	Foamed clay light clay supplied in big bags (1 m³/big bag), naturally moist malleable mass, grain size: 4 – 16 mm ; dry weight approx. 600 – 700 kg/m³; supplied on euro pallets	Big Bag	1	1000	
03.055	Foamed clay light clay supplied in big bags (1 m³/big bag), naturally moist malleable mass, grain size: 4 – 8 mm ; dry weight approx. 600 – 700 kg/m³; supplied on euro pallets	Big Bag	1	1000	
03.011	Wood-chip light clay supplied in big bags (1 m³/big bag), naturally moist malleable mass; dry weight: ~600 – 700 kg/m³; supplied on euro pallets Produced on request	Big Bag	30	1000	

• Wire-bound every 10 cm

Reed

		Packaging unit	Sales unit	Weight kg/packaging unit	
34.002.1	Reed plaster base mesh, 70 stems per metre, roll: 1.50 × 10 m, wire-bound every 10 cm; supplied on euro pallets	Roll	1	6.6	
34.010	Reed board, thickness: 50 mm, 1 × 2 m; supplied on euro pallets	Item	1	19	
34.020	Reed board, thickness: 20 mm, 1 × 2 m; supplied on euro pallets	Item	1	7.6	

Reed plaster base mesh is used as a plaster base or permanent formwork for holding light earth fill material in place. The reed stems are bound together with galvanized iron wire with approx. 70 stems per metre. The stems are bound together every 10 cm. Reed boards are mats of reed stems pressed together into boards and wire-bound every 14 – 18 cm on both sides. All wire bindings are galvanized.

Light clay wall linings

Light clay mixtures are a naturally-moist malleable mass of material that is inserted as loose internal insulation between the inner face of an external wall and a permanent formwork construction. This construction makes it possible to even out irregularities in the existing wall.



Please see our work sheet 2.2 Light clay wall linings.

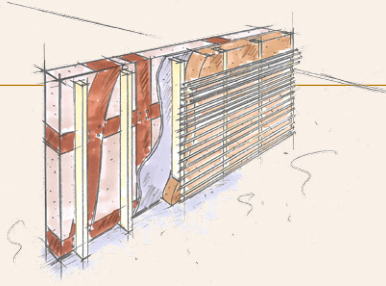

Clay panels

NEU

- Drywall construction with clay
- Made in Germany

		Packaging unit	Sales unit	Weight kg/packaging unit
CP Type A – TM 07 – MHK II – 1,6 – 16 mm				
09.008	conluto clay panel, 16 mm, Premium 125 × 62.5 cm; 0.781 m²/panel, with hessian backing on one side, 60 panels shrink-wrapped on one-way pallets (= 46.86 m²)	m²	0.781	23
CP Type A – TM 07 – MHK II – 1,6 – 22 mm				
09.004	Clay panel, 22 mm, Premium 125 × 62.5 cm; 0.781 m²/panel, with hessian backing on one side, 40 panels shrink-wrapped on one-way pallets (= 31.24 m²) hessian backing on one side	m²	0.781	32.0
10016	Fastening plates, Ø 36 mm with Ø 5 mm perforations, conical sheath for screw head, for fastening clay panels, 100 pieces	Box	1	0.44



Clay panels are used for cladding partitioning walls and as dry lining for timber frame or timber post constructions. They are suitable for interior use only and are then covered with a coat of clay plaster.

Rammed earth
for walls and floors

- Minimal shrinkage

		Packaging unit	Sales unit	Weight kg/packaging unit
02.004	Rammed earth, natural brown, (1.3 t/big bag), grain size Ø 0 – 8 mm	Big Bag	1	1300
02.005	or 0 – 22 mm; supplied shrink-wrapped on euro pallets			
02.004.01	Rammed earth, natural brown, (0.7 t/big bag), grain size Ø 0 – 8 mm	Big Bag	1	700
02.005.01	or 0 – 22 mm; supplied shrink-wrapped on euro pallets			
02.003..	Rammed earth, coloured, (1.3 t/big bag), grain size Ø 0 – 8 mm	Big Bag	1	1300
02.006..	or 0 – 22 mm, colours: sandstone beige, sandstone yellow, sandstone red, gneiss; supplied shrink-wrapped on euro pallets			
02.003..	Rammed earth, coloured, (0.7 t/big bag), grain size Ø 0 – 8 mm	Big Bag	1	700
02.006..	or 0 – 22 mm, colours: sandstone beige, sandstone yellow, sandstone red, gneiss; supplied shrink-wrapped on euro pallets			



Rammed earth can contain particles as large as 22 mm. Rammed earth can also be used to construct load-bearing walls. The bulk density ranges from ~1700 to 2300 kg/m³. conluto provides rammed earth in its natural brown colour, or with earth of different colours including sandstone beige, sandstone yellow, sandstone red and gneiss. 1 m³ of naturally moist rammed earth material is required for ~0.65 m³ finished rammed earth wall or floor.

conluto clay panels

conluto clay panels are dry lining boards used for cladding internal walls, timber stud walls and subconstructions and for dry lining internal walls, roof spaces and suspended ceiling constructions. They combine the simplicity of dry lining construction methods with the excellent climatic properties of earth as a building material.

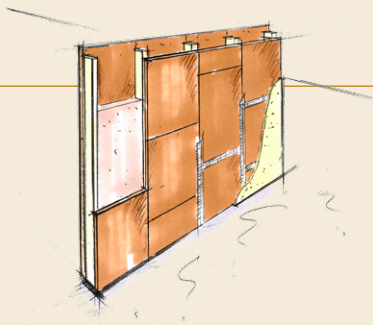

Surface treatments

for smoothing plaster and rammed earth

		Mengen- einheit	Sales unit	Weight kg/packaging unit
00.420.1	Carnauba wax emulsion, surface treatment for smoothed clay plaster (coverage: 15 – 20 m²/l) and rammed earth floors and walls (coverage: 5 – 7 m²/l); 1 l	Bottle	1	1.2
00.420.2	Carnauba wax emulsion, surface treatment for smoothed clay plaster (coverage: 15 – 20 m²/l) and rammed earth floors and walls (coverage: 5 – 7 m²/l); 5 l	Canister	1	5.5
00.421	Hard wax emulsion, surface finish treatment for rammed earth floors, 1 kg; coverage: 20 – 40 m²/kg	Item	1	1

Carnauba wax emulsion, when applied undiluted to the floor, reduces the degree of mechanical abrasion, dirt accumulation and moisture ingress, while preserving the vapour permeable quality of the material and lending smooth clay plaster surfaces a glossy sheen.

High-mass earth bricks
extruded

		Packaging unit	Sales unit	Weight kg/packaging unit
Earth bricks – non-load-bearing – DIN 18945 – LS s – II				
06.010	Earth bricks DF, solid, bulk density ~1800 kg/m³, 448 bricks/ shrink-wrapped pallet, (DF = Thin Format: 240 × 115 × 52 mm); application class II, non-load-bearing	Bricks	448	2.85
06.012	Earth bricks NF, solid, bulk density ~1800 kg/m³, 336 bricks/ shrink-wrapped pallet, (NF = Normal Format: 240 × 115 × 71 mm); application class II, non-load-bearing	Bricks	336	3.7
06.020	Earth bricks 2 DF, perforated, bulk density ~1600 kg/m³, 224 bricks/ shrink-wrapped pallet, (2DF = 2 × Thin Format: 240 × 115 × 113 mm); application class II, non-load-bearing	Bricks	224	4.9

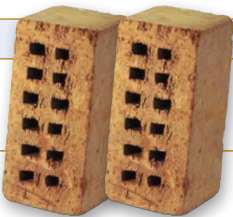

High-mass earth bricks are used for panel infill in timber-frame constructions, as weighting for floors, as wall lining and for dry stacked walls. The bricks are application class II and are not suitable for outdoor or external wall applications.

Earth bricks – non-load-bearing – DIN 18945 – LS sg – III

06.021	Earth bricks 3 DF, perforated, bulk density ~1600 kg/m³, 160 bricks/pallet, (3DF = 3 × Thin Format: 240 × 175 × 113 mm)	Bricks	160	7.3
--------	---	--------	-----	-----

Application class III bricks may only be used for dry applications.



Earth masonry mortar, dense bearing

• Earth masonry mortar in accordance with DIN 18946

		Packaging unit	Sales unit	Weight kg/packaging unit
Naturally moist Earth masonry mortar DIN 18946 – LMM 04 m – M 2 – 1,8				
05.020.1	Earth masonry mortar; for use with high-mass earth bricks; supplied shrink-wrapped on euro pallets	Big Bag	1	1300
05.020.2		Big Bag	1	700

Quantities required according to usage table (see conluto product folder, printed or online).

Dense earth masonry mortar is a ready-mixed, naturally moist mortar made of ground clay-rich earth, mixed grain sand of grain size Ø 0 – 2 mm. It is for use with high-mass earth bricks.

Loam fill material

		Packaging unit	Sales unit	Weight kg/packaging unit
01.004.1	Loam fill material (1 t/big bag), sieved granulate with grain sizes of Ø ~2 – 10 mm; residual moisture level: 10 – 14 %; density ~1000 – 1200 kg/m³ after compaction; supplied shrink-wrapped on euro pallets	Big Bag	1	1000
01.004.2		Sack	40	25

Loam fill material is used to increase the mass of ceilings. This is for noise (not thermal) insulation purposes.

Trickle protection fleece

		Packaging unit	Sales unit	Weight kg/packaging unit
35.103.4	Trickle protection fleece, black, 1.5 m wide, 50 linear m/roll	Roll	1	4.125

Trickle protection fleece prevents dust and particles from trickling out of floor cavities filled with loam fill material into the room below.

Straw-clay

		Packaging unit	Sales unit	Weight kg/packaging unit
04.001.1	Straw-clay, naturally-moist mass, in big bags (1 t/big bag); supplied on euro pallets Produced on request	Big Bag	1	1000

Straw-clay mixtures are a mixture of earth and straw with a density of up to 1200 kg/m³. The mixture is used as a daub for wattle constructions and as a ceiling fill material applied to supporting stakes.

Building clay

		Packaging unit	Sales unit	Weight kg/packaging unit
01.003.1	Building clay, naturally moist, supplied in big bags (1.3 t/big bag); ground grain size Ø < 5 mm; supplied shrink-wrapped on euro pallets	Big Bag	1	1300
01.002	Building clay, dry, powdered, supplied in big bags (1.2 t/big bag), ground grain size Ø < 0.5 mm; supplied shrink-wrapped on euro pallets	Big Bag	1	1200
10.060	Building clay, powdered, packaged in sacks, ground grain size Ø < 0.5 mm, 25 kg/sack, 42 sacks; supplied shrink-wrapped on euro pallets	Sack	1	25

Used as a binder for earth building materials.

Earth reels

		Packaging unit	Sales unit	Weight kg/packaging unit
30.101	Earth reels, oak; supplied shrink-wrapped on euro pallets	Item	1	–

Earth reels are used as infill between ceiling joists in floors and timber-frame wall constructions, as well as in the renovation of existing half-timbered structures. They consist of oak stakes around which a mat of long stems of clay-soaked straw is wrapped, much like a reel. The earth reels are delivered in a still moist condition and should be inserted into the structure before they dry. It is therefore important that frost-free conditions prevail. We prepare the earth reels at the length you specify.

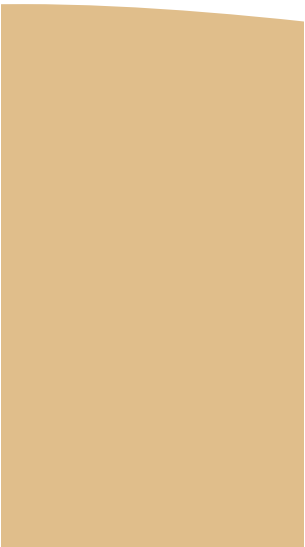

Plant fibres and animal hair

		Packaging unit	Sales unit	Weight kg/packaging unit
32.010	Pig bristles, washed, 5 kg/box	Box	1	5
32.011	Hemp fibre, length ~3 mm, 7 kg/bag	Bag	1	7
32.012	Calf hair, washed, chopped, 5 kg/box	Box	1	5
33.021	Chopped straw, barley, (1 m³/big bag), length: ~30 mm	Big Bag	1	80
33.021.1	Chopped straw, barley, (1 m³/big bag), length: ~8 mm	Big Bag	1	100

Plant fibres and animal hair are used as clay plaster reinforcement. All animal hair has been washed.

Where can I get conluto® products?
Where can I find qualified conluto® tradesmen?

For further information on our network of stockists and distributors, please contact us or visit our homepage:

www.conluto.de

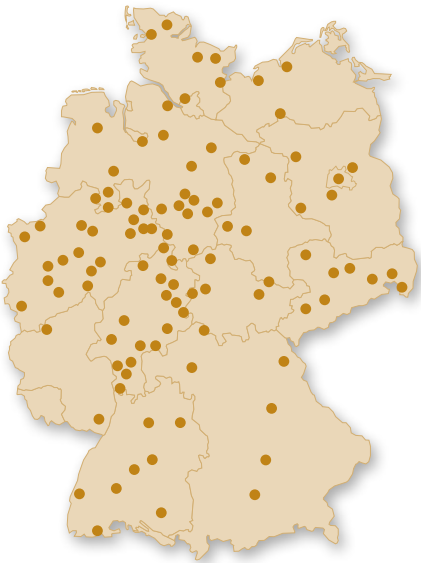

The conluto team

We can provide competent assistance on all aspects from the production of our products and the logistics of their provision and delivery to technical advice and support on their use and application as well as marketing support.



Technical support

Phone +49 (0) 5235 50257-0
Fax +49 (0) 5235 50257-13
E-Mail info@conluto.de

Product folder

Our conluto product folder provides a wealth of important information from quantities tables to work sheets to technical information sheets on preparing and using our earth building products.



Advertising material catalogue

For additional advertising material (brochures, samples or give-aways) please ask us for our advertising material catalogue.



Member of the
Dachverband Lehm e.V.





Thinking, feeling and designing with earth

All that we do revolves around earth. Out of this most unique building material we have been producing high-quality earth building products since 1993. Founded by Jörg Meyer, conluto successfully unites tradition and innovation. From its beginnings as an earth building contractor, conluto has grown to become an internationally active supplier. On its 14000 m² large site, conluto now produces a range of earth building products including clay plasters in naturally moist and dry consistencies, deco facing plasters, earth mortars, clay paints and rammed earth.

Top quality and a cooperative working relationship with our clients – that is our motto.

Your local conluto representative

Clay plasters and paints
Renovation systems
Modern earth building products
Building restoration materials

Training and education
Logistics and organisation
Special solutions and custom production
Advice on products, building and renovation

conluto®

Jörg Meyer
Detmolder Straße 61 – 65
32825 Blomberg | Istrup
Phone +49 (0) 5235 50257-0
Fax +49 (0) 5235 50257-13
E-Mail info@conluto.de

www.conluto.de

